

# BRCL66R-70W

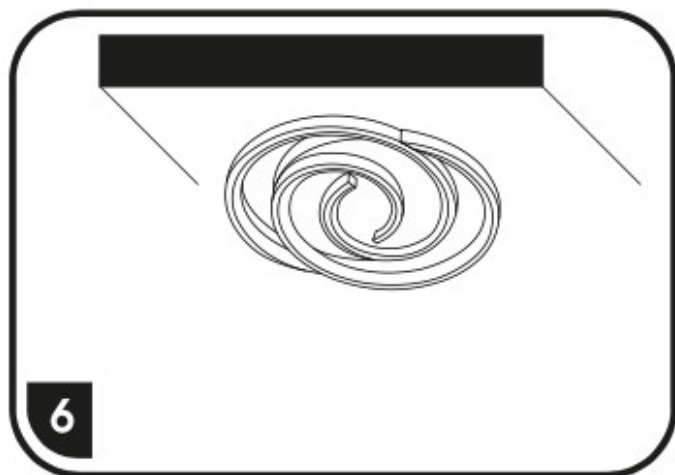

< 5,5 >

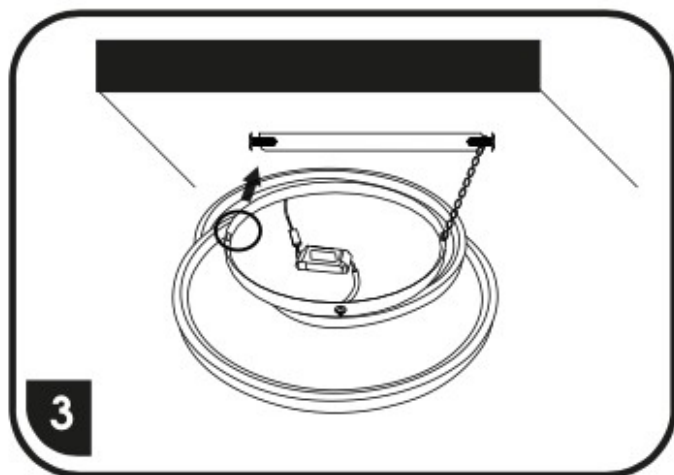
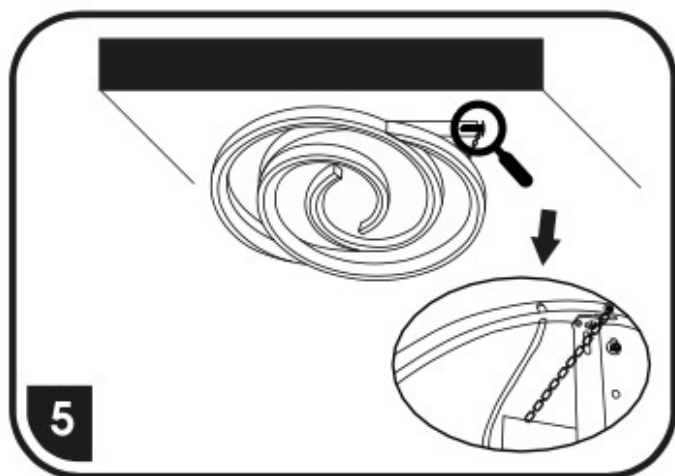
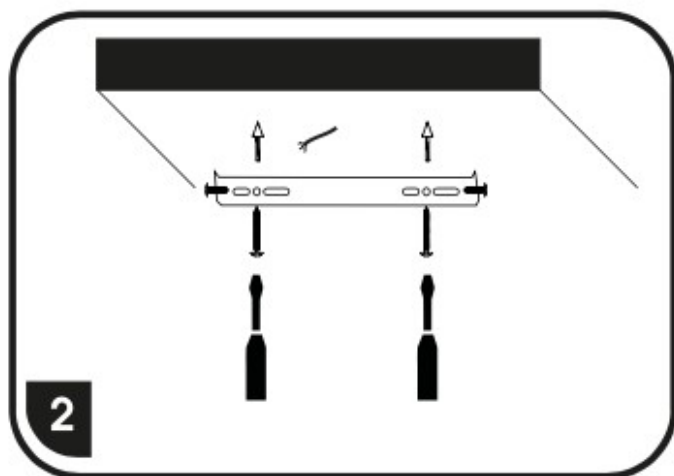
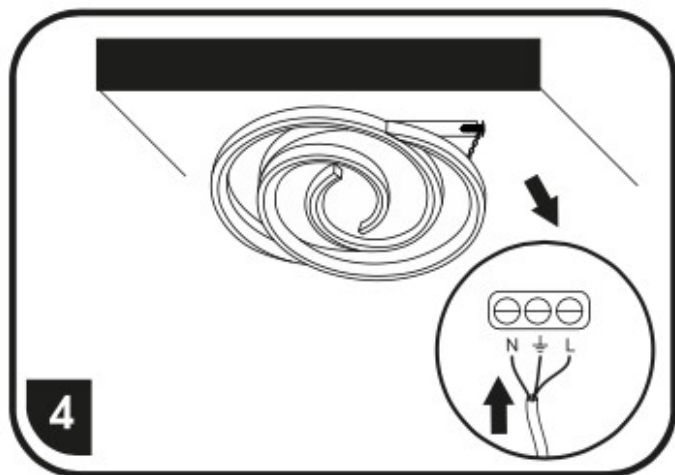
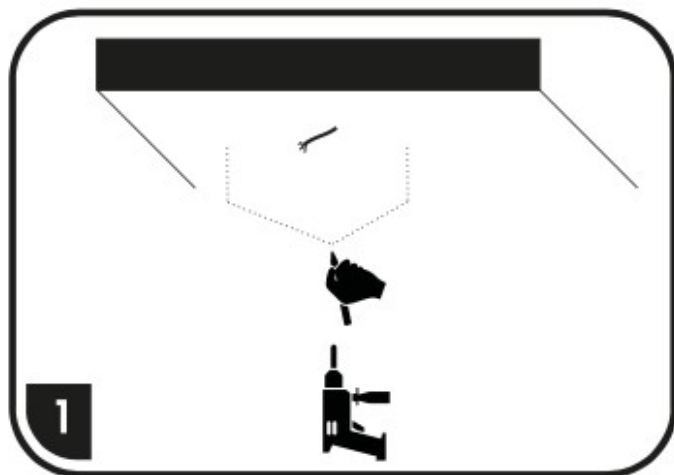
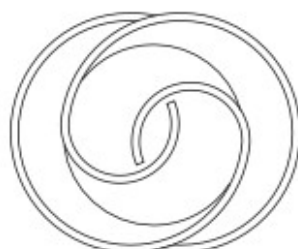

Ø 48,0

If the remote control is not communicating with the light, pair them.

### Pairing of the light and remote control

-turn on the light by the wall switch and within 3 seconds, the pairing button  will be shortly pressed (the light will flash one time and that means that the pairing is done).

### Unpairing the light and remote control

-firstly, press the turn on button  and hold it, the light will turn on and within 3 seconds the light will flash one time and that means that the unpairing is done.

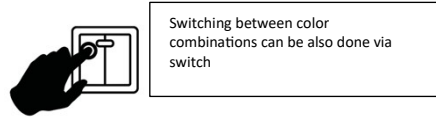

THE LIGHTS ARE ALREADY PAIRED WITH THE REMOTE CONTROL BY THE MANUFACTURER

